

**ABODO**

**Carefully Crafted Timber**



# About Abodo

## Carefully Crafted Timber

### Our Craft

Abodo crafts timbers with lasting beauty that are safe for people and the environment.

Our timbers stand the test of time, they are beautiful, durable and rapidly renewable.

Formed in 2001 by the Gudsell family, Abodo remains a New Zealand-owned, family business with a purpose.

### Our Philosophy

Our design ethos has two core components:

#### Lifetime beauty

Abodo timbers are crafted to be enjoyed for years to come. Designed to age with grace, our timbers have exceptional weatherability and maintain their durability and beauty for a lifetime.

#### With tomorrow in mind

Our timbers are harvested from New Zealand's FSC® certified rapidly renewable plantation forests. They are ethically crafted with respect from beginning to end – allowing us to meet today's increasing needs without disadvantaging future generations.

# Vulcan Cladding and Vulcan Nexus Cladding



Vulcan Cladding (WB10 Profile 138x20) in Protector - Ebony

## Overview

**Vulcan Cladding** is a tongue and groove cladding system ethically crafted from New Zealand plantation Radiata Pine making it a truly sustainable timber. Abodo uses world class thermal modification technology to convert the pine to a highly durable exterior timber. The thermally modified pine is then engineered with a unique vertical grain orientation to gain outstanding strength and stability.

Unlike typical European softwoods, our pine is free of knots and other visual defects. Our Red List Free termite treatment gives peace of mind and our applied fine sawn finish ensures superior coating performance to reduce maintenance.

When compared to knotty appearance timbers and traditional hardwoods, the above combination gives Vulcan Cladding superior stability, no resin leaching and long term durability.

Abodo Vulcan Cladding is a clear choice when you consider 30+ year life expectancy, 15 year warranty, FSC certification, Environmental Product Declaration, speed of installation, excellent technical support and many high quality projects to reference.

**Vulcan Nexus Cladding** is Vulcan Cladding with an additional finger joining process to allow an extended range of set lengths to meet builder requirements.

Ensure adequate inspection of samples, existing projects and other references prior to selecting Vulcan Cladding or Vulcan Nexus Cladding.

Refer to relevant Technical Design Sheets and Manuals for installation, maintenance and other instructions.

## Standard profiles:



WB10 138x20\*\*  
(118mm cover) Vertical/horizontal



WB10 180x20\*  
(160mm cover) vertical/horizontal



WB12 90x20\*  
(70mm cover) vertical only



WB12 90x40\*  
(70mm cover) vertical only



WB12 90x60\*  
(70mm cover) vertical only



WB12 138x20\*\*\*  
(118mm cover) vertical only



WB12 180x20\*  
(160mm cover) vertical only



WB12F 180x20\*  
(160mm cover/76mm face/4mm groove)  
vertical only

\*Available only in Vulcan Cladding.

\*\*Available in both Vulcan Cladding and Vulcan Nexus Cladding.

\*\*\*Available only in Vulcan Nexus Cladding.

Standard surface finish is fine band sawn. Brushed finish available on request.

## Lengths:

**Vulcan Cladding** – Typical: 4.2m and 4.8m.

**Vulcan Nexus Cladding** – Typical: 3.6m, 5.4m and 6.0m.

Lengths are subject to availability at time of order. Please check with local resellers for pricing, availability, and lead times.

## Coating colours:

Refer to Vulcan Nexus Screening and Vulcan Screening over page for Protector coating colour information.



Protector  
Nero



Protector  
Ebony



Protector  
Walnut



Protector  
Graphite

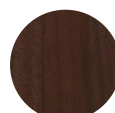

Protector  
Teak

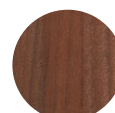

Protector  
Natural



Protector  
Patina



Protector  
Straw



Sioox\*

## Carefully Crafted Timber

\* Sioox is a specialist 3 coat exterior coating system for a long term silver weathered look. Refer Sioox Manual [abodo.com.au](http://abodo.com.au)

# Vulcan Nexus Screening and Vulcan Screening



Vulcan Screening (180x42) in Protector - Teak

## Overview

**Vulcan Nexus Screening** is a range of high performing battens, beams and posts created from New Zealand pine that has been thermally modified, finger jointed and laminated (GL8 rated). This combination results in stability, straightness, and spanning capability unable to be met by other commonly used timbers. No resin leaching gives peace of mind. The finger joint clears grade ensures a superior aesthetic free of knots and other defects prominent with knotty softwoods.

The finger joining process allows long lengths (6m and above) as well as a range of set lengths to meet design requirements, reduce material waste and reduce installation time. Vulcan Nexus Screening is readily available in a range of set lengths throughout Australia via our Reseller network.

Applications: facade screening/fins, balustrades, pergolas, joinery (windows/doors), interior feature battens.

**Vulcan Screening** is not finger jointed and is made from laminated clears grade timber with lengths typically 4.2m or 4.8m. Vulcan Screening may be a good choice for interior applications. Please enquire with our Reseller network for options and availability.

Ensure adequate inspection of samples, existing projects and other references prior to selecting Vulcan Nexus Screening or Vulcan Screening.

Refer to Abodo's Screening Design Guide and relevant Technical Design Sheets for installation, maintenance and other instructions.

## Lengths:

**Vulcan Nexus Screening** – Typical: 3.6m, 5.4m and 6.0m.

**Vulcan Screening** – Typical: 4.2m and 4.8m.

Lengths are subject to availability at time of order. Please check with local resellers for pricing, availability and lead times.

## Sizes:

### Finished dimensions

42 x 18	65 x 25	32 x 32	42 x 42	88 x 65	138 x 88	138 x 138
65 x 18	88 x 25	42 x 32	65 x 42	138 x 65	180 x 88	180 x 138
88 x 18	138 x 25	65 x 32	88 x 42	180 x 65		
138 x 18	180 x 25	88 x 32	138 x 42	290 x 65		
180 x 18		138 x 32	180 x 42			
		180 x 32	238 x 42			
		290 x 32	290 x 42			

All sizes are stocked in Vulcan Nexus Screening as standard to meet demand for set lengths. Standard surface finish is fine band sawn. Smooth Dressed finish available on request.

## Coating colours:

Colours are indicative only and as they would appear on Vulcan timber. Protector is a pigmented penetrating natural oil and is an Abodo proprietary product.

Colour may change/fade as a part of the natural weathering process. See [abodo.com.au](http://abodo.com.au) for Maintenance Guide.

Vulcan Screening/Cladding is usually factory pre-coated with 1 or 2 coats in a colour as selected.



Protector Nero



Protector Ebony



Protector Walnut



Protector Graphite

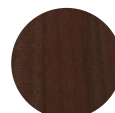

Protector Teak



Protector Natural



Protector Patina



Protector Straw



Sioo:x\*

\* Sioo:x is a specialist 3 coat exterior coating system for a long term silver weathered look. Refer Sioo Manual [abodo.com.au](http://abodo.com.au)

# Vulcan Panelling



Vulcan Panelling (TG9 Profile 140x10) in Protector - Teak

## Overview

**Vulcan Panelling** is a ceiling and wall lining created from thermally modified New Zealand plantation pine and then engineered with a unique and patented vertical grain for superior stability and minimal movement. Refer [Vulcan Cladding Overview](#). This allows us to produce a 10mm lining board for better economy and faster installation.

Vulcan Panelling is an excellent and beautiful choice for interior ceilings, interior walls, exterior soffits, exterior protected applications (e.g. walls not fully exposed to weather).

Refer to relevant Technical Design Sheets for installation, maintenance and other instructions.

## Standard profiles:



TG9 – 140x10 (135mm cover) reversible profile



TG9 – 180x10 (175mm cover) reversible profile



TG18 – 141x10 (133mm cover)



TG19 – 141x10 (133mm cover)

Profiles supplied with smooth dressed finish.  
Other custom profiles are available but may be subject to minimum order quantities.

## Lengths:

Fixed length packs – 4.2, 4.8m.

Lengths are subject to availability at time of order. Please check with local resellers for pricing, availability, and lead times.

## Finish and coating:

Vulcan Panelling is supplied uncoated and with a machine quality smooth dressed finish. This may be adequate or sanding on site prior to coating by the customer may be preferred. Coating may be Abodo's Protector oil or another product as selected by the customer.

# Vulcan Cladding – Quantity Calculator

Band Sawn Finish – Select Grade – Protector Coating.

Profile	Width	Depth	Orientation	Cover (mm)	Cavity batten centres (mm)	Fasteners (Pieces/lm)	Fasteners (Pieces/m <sup>2</sup> )	Lineal metres/m <sup>2</sup>	Protector first coat sq metres/litre*	Protector second coat sq metres/litre*
Vulcan WB10/WB12	138 x 20	Vertical		118	600	1.67	14.14	8.47	6-8	10-12
Vulcan WB10/WB12	180 x 20	Vertical		160	600	1.67	10.44	6.25	6-8	10-12
Vulcan WB12	90 x 40	Vertical		70	600	1.67	23.86	14.29	7-9	9-11
Vulcan WB12	90 x 60	Vertical		70	600	1.67	23.86	14.29	7-9	9-11

**Notes:**

- Quantities given do not allow for wastage or additional fasteners needed for detailing/mouldings.
- Final order quantities are the buyer's responsibility and should be checked and verified prior to order placement.
- Abodo will not accept liability for over or under-ordered items.
- \* Coating quantities are for softwood and approximate only and may vary depending on application method and rate. First coat is usually factory applied by Abodo. Second coat is usually applied on site by builder.

For further information on product handling, fastener types and installation go to [www.abodo.com.au/resources](http://www.abodo.com.au/resources)

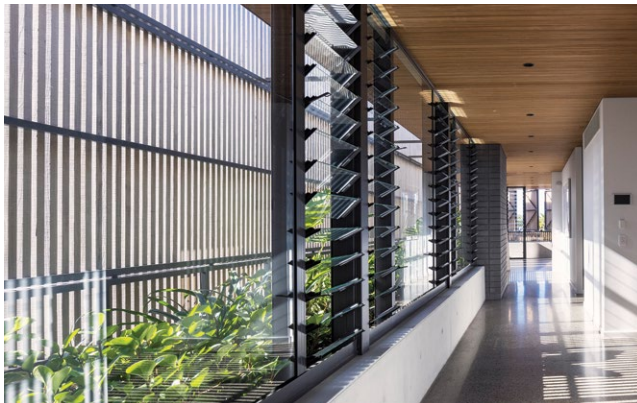

Vulcan Screening in Protector - Teak



Vulcan Panelling and Joinery (Custom Profiles) in Protector - Teak



Vulcan Screening in Protector - Straw



Vulcan Nexus Cladding in Protector - Graphite

# Vulcan Cladding – Mouldings

Standard exterior mouldings:

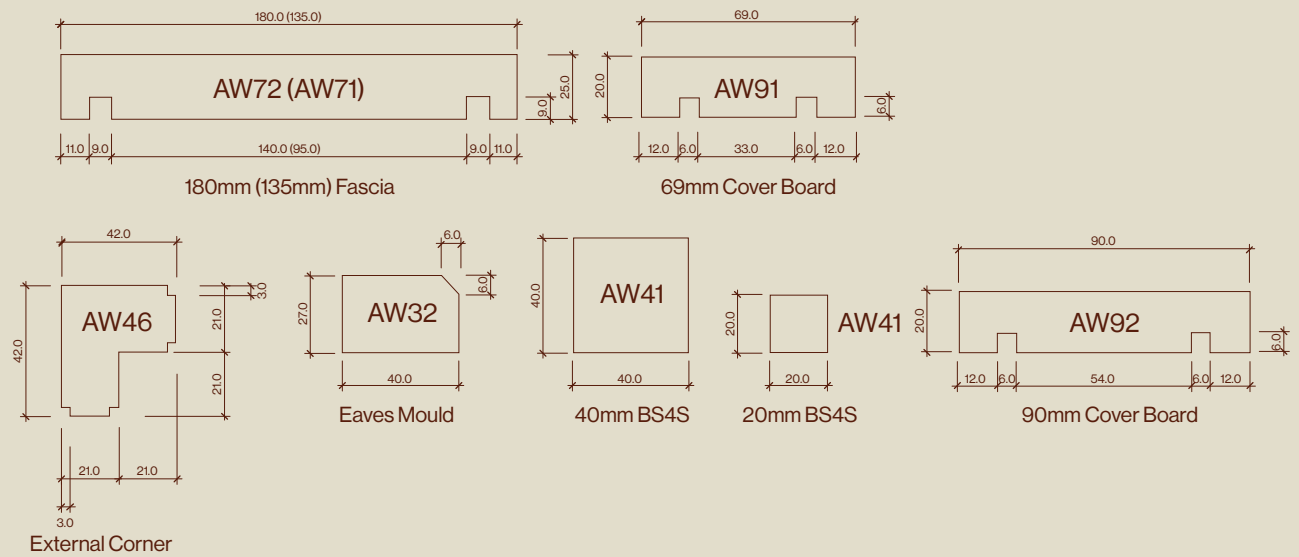

Note:

- Mouldings usually supplied pre-coated by Abodo with 1 coat Protector in colour as selected. The second coat is applied on site by the builder after cladding installation.
- Mouldings generally supplied in 4.2m lengths unless advised otherwise.

## Coatings

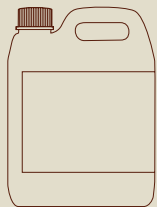

**Protector**  
4L, 10L

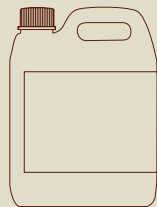

**Protector – End Seal**  
1L bottle



**Sioo:x**  
1L, 5L (Part 1 and 2)

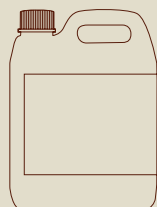

**Sioo:x Maintenance Wash**  
1L

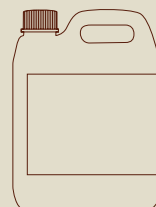

**Sioo:x End Grain Sealer**  
1L (Part 1 and 2)

Notes:

- Protector is a high performance plant based exterior penetrating oil developed and tested by Abodo. See previous pages for available stain colours. Refer to Technical Data Sheet at [www.abodo.com.au/resources](http://www.abodo.com.au/resources)
- Protector – End Seal is a specialised clear sealer for end grain protection.
- Sioo:x is a specialised 3 coat system (2 coats of Part 1 and 1 coat of Part 2) for a high performance silver weathered appearance. Refer [abodo.com.au/resources](http://abodo.com.au/resources)



**W** [brittontimbers.com.au](http://brittontimbers.com.au)

Contact Abodo's sales and distribution partner, Britton Timbers:

**Britton Timbers NSW**

**P** (02) 8783 9900  
116-118 Jedda Road  
Prestons, NSW 2170  
[sales.nsw@brittontimbers.com.au](mailto:sales.nsw@brittontimbers.com.au)

**Britton Timbers QLD, NT**

**P** (07) 3888 3351  
100 Potassium Street  
Narangba, QLD 4504  
[sales.qld@brittontimbers.com.au](mailto:sales.qld@brittontimbers.com.au)

**Britton Timbers VIC, SA, TAS**

**P** (03) 8769 7111  
25 Gaine Road  
Dandenong, VIC  
[sales.vic@brittontimbers.com.au](mailto:sales.vic@brittontimbers.com.au)

