

The CLADDING
COLLECTION

Luxury meets longevity

TIMBER CLADDING THAT LASTS A LIFETIME

accoya  |  BRITTON
TIMBERS



Revitalising your homes exterior

With the cladding collection you can enjoy style, low maintenance and exceptional durability that outperforms even the most resilient hardwoods.

Every board is 100% real wood, enhanced through advanced innovation and engineered to perform with uncompromising precision against the elements.

Not all cladding is created equal.

Made from responsibly sourced timber, it delivered the natural aesthetic of wood with performance built in

Whether coated, textured, or left natural, Accoya stands the test of time delivering lasting beauty, stability, and performance in every finish.

An Innovative Technology Resulting in the Highest Performing Real Wood Cladding Boards Ever Created

We've mastered a time-tested wood modification process called acetylation. This technology transforms wood to create the only real wood cladding boards to deliver the ideal combination of stability and longevity.

While others may attempt wood modification, no one does it like Accoya. Our proprietary process uses precision science to transform wood at the molecular level. This reaction permanently changes the wood's cell structure, creating a natural resistance to the effects of water.



The result, the world's best performing real wood cladding boards that resist rotting and stay free of any visible distortion over its lifetime. A cost-effective choice for lasting performance. Accoya reimagined real wood to deliver powerful results worthy of our transferable 50-year warranty.

Only wood's naturally occurring components are added, creating a 100% real wood, non-toxic product.

Benefits that last a lifetime

Exceptional performance in all conditions

Built to endure where others fall short, Accoya cladding is engineered for outstanding stability and resilience in even the most demanding environments. From intense sun and rain to humidity, frost, and coastal exposure, it maintains its shape, strength, and refined appearance.



50 YEAR TRANSFERABLE WARRANTY

Confidence built into every façade. Accoya cladding is backed by an industry-leading 50-year warranty above ground, reflecting its exceptional durability and long-term resistance to rot and decay.



SUSTAINABILITY SOURCED AND CERTIFIED

Accoya cladding is crafted from 100% responsibly sourced timber, giving you the confidence that your design choices are sustainable and ethical. Every board carries the Cradle to Cradle® certification at the Gold Level, meeting rigorous standards for material health, circularity, and environmental stewardship.



VERSATILE FINISHING OPTIONS

Accoya cladding adapts to your design vision with a range of finishing possibilities. Whether you prefer a rich, coated surface, a subtle stain, or the natural warmth of uncoated wood, Accoya retains its stability and beauty over time. Its exceptional performance ensures coatings adhere longer and colours stay true, allowing you to create façades that are as unique and enduring as your architecture.



AUSTRALIAN TERMITE RESISTANT

Accoya cladding is naturally resistant to Australian termites, providing long-lasting protection for your exterior projects. Its unique structure keeps termites at bay while maintaining the natural beauty and stability of the wood.



Here at Britton Timbers we offer a premium range of cladding solutions designed to elevate any exterior with last beauty.

From sleek, contemporary lines to Accoya cladding comes in a variety of styles to suit any homes vision.



PRODUCT SPECIFICATIONS

PROFILE	DIMENSIONS	COLOUR	COATING
T&G	129(c)x19mm	Natural	Uncoated
T&G	129(c)x19mm	Natural	Coated
T&G	129(c)x19mm	Slate Grey	Not required
Battons / Screening	Various	Natural	Optional
Battons / Screening	Various	Slate Grey	Not required

T&G PROFILE

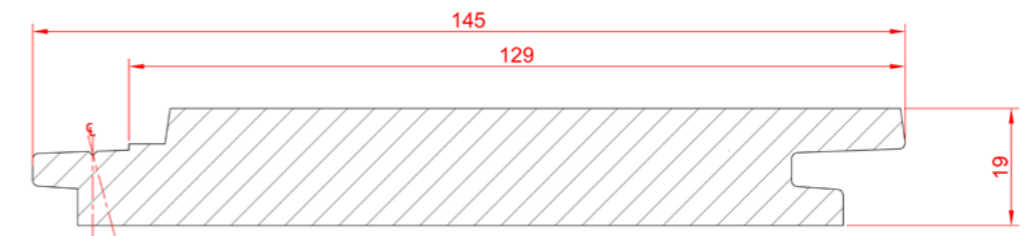

Coatings last longer on Accoya

Dark coatings on timber often pose challenges, as shrinkage and swelling are amplified by solar heat and high UV exposure, especially in extreme climates. Accoya eliminates these concerns.

Its superior dimensional stability ensures that even dark or black finishes remain flawless, while dramatically extending maintenance intervals.



Performance meets sustainability

Accoya cladding transforms façades into a statement of enduring style, quality, and sustainability.

PERFORMANCE ATTRIBUTES

Resistant to decay, rot, termites, and the harshest climatic conditions, Accoya cladding offers unmatched dimensional stability, reducing warping, swelling, and shrinking.



SUSTAINABILITY

Made from responsibly sourced timber and Cradle to Cradle® certified at the Gold Level every product supports environmentally responsible construction and long-term circularity.



Declare.



WARRANTY & ASSURANCE

Backed by a 50-year above-ground warranty, Accoya cladding provides confidence in both durability and performance for decades.



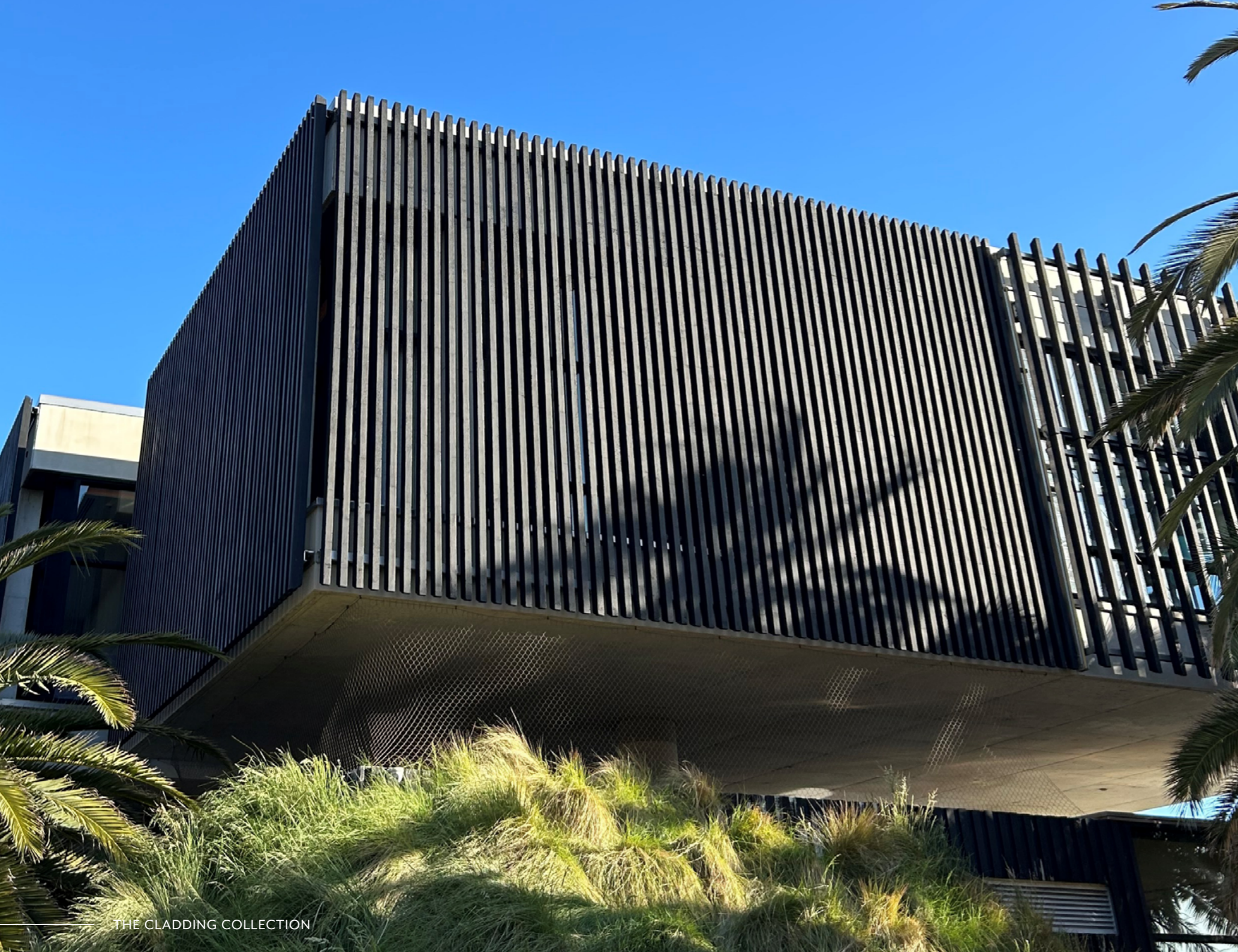

Revitalising your homes exterior

With our premium cladding collection you can enjoy exceptional style, low maintenance and outstanding durability.

Designed to outperform even the most resilient hardwoods, our high performance cladding is proven to stand the test of time.

MELBOURNE STOKE HOUSE

Installed in 2015

Even after 10+ years in a salty and humid coastal environment Accoya wood remains structurally sound.

The CLADDING
COLLECTION

accoya  |  BRITTON
TIMBERS

brittontimbers.com.au
